

GN 115.8

Hook-type latches

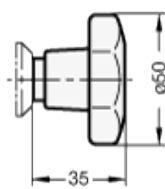

Type SG

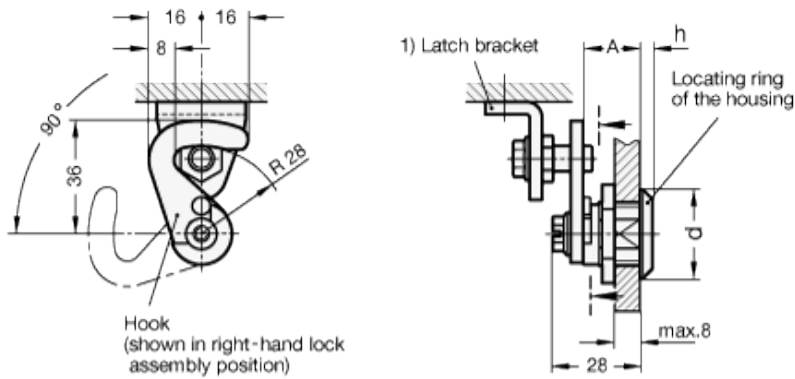
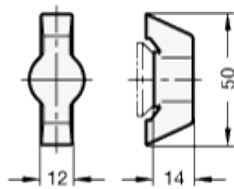

Type SK

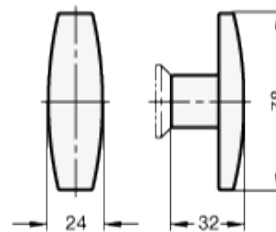

Type ST

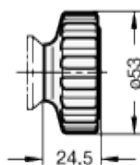

Type RG

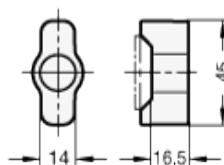

Type KG

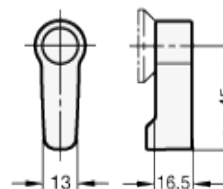

Type HG



Locating ring

- Chromium-plated CR
- RAL 9005 black colour SW, matte finish, epoxy resin coating.

Metal elements

Zinc-plated steel, blue passivated.

Wrench / T-Handle

Plastic (Polyamide PA), black matt.

Cover cap (type RG, KG, HG)

light grey

Standard versions available

- Type SG: Operation with star knob.
- Type SK: Operation with wrench.
- Type ST: Operation with T-Handle.
- Type RG: with knurled knob (GN 7336).
- Type KG: Operation with wrench.
- Type HG: Operation with Lever.

Version of the hook

- Version H1 Pivot radius R=28.

Identification no.

- Identification no. 1 without latch bracket
- Identification no. 2 with latch bracket

Accessories on request

- Hook type latches with other hook distance A.
- Hook with other pivoting radius R.

Features and applications

Hook-type latches GN 115.8 with hook and latch bracket are mainly used for sliding doors and flaps. The locking Action is in radial direction to the axis of Rotation, resulting in a wide variety of different uses. Two keys are supplied with the unit. The key can be removed in both end positions. Hook-type latches GN 115.8 are supplied with the hook enclosed loose.

Standard Elements	Main dimensions			Weight
	A	d	h	g
GN 115.8-SG-18-H1-1-*	18	28	4	110
GN 115.8-SK-18-H1-1-*	18	28	4	92
GN 115.8-ST-18-H1-1-*	18	32	6	131
GN 115.8-RG-18-H1-1-*	18	32	6	108
GN 115.8-KG-18-H1-1-*	18	32	6	85
GN 115.8-HG-18-H1-1-*	18	32	6	87
GN 115.8-SG-18-H1-2-*	18	28	4	150
GN 115.8-SK-18-H1-2-*	18	28	4	132
GN 115.8-ST-18-H1-2-*	18	32	6	171

GN 115.8-RG-18-H1-2-*	18	32	6	148
GN 115.8-KG-18-H1-2-*	18	32	6	125
GN 115.8-HG-18-H1-2-*	18	32	6	90

*Complete the description of the standard item needed by adding CR (chrome plated) or SW (black, RAL 9005, textured finish).



STANDARD MACHINE ELEMENTS WORLDWIDE