

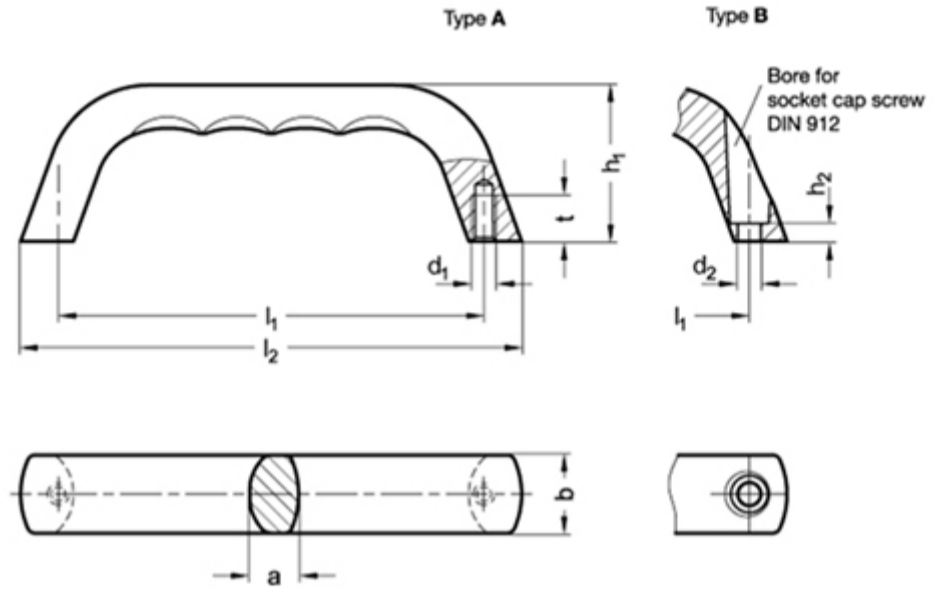

**GN 328.5**  
**Cabinet „U“ handles**  
 Stainless Steel



	$l_1 \pm 0.25$	a	b	d1	d2	h1	h2	l2	t	
<b>Description</b>										
GN 328.5-120-A-GS	120	14	22	M 6	-	44	-	141.2	13	318
GN 328.5-120-B-GS	120	14	22	-	6.5	44	5	141.2	-	293
GN 328.5-140-A-GS	140	18	28	M 8	-	55	-	166.5	17	601
GN 328.5-140-B-GS	140	18	28	-	8.5	55	6	166.5	-	523



## Specification

### Types

- Type **A**: Mounting from the back (threaded blind bore)
- Type **B**: Mounting from the operator's side

Stainless Steel-precision casting  
 matte shot-blasted **GS**

## Information

GN 328.5 Stainless Steel-Cabinet "U" handles have excellent stability and ergonomic design. The finger recesses on the underside of the handle provide a specially comfortable grip.

## On request

- other finishes

## Technical information

- [Stainless Steel characteristics](#)